

LC-L

LC-L stop bead with glass fibre mesh for clean plaster finishing in thermal insulating system – ETICS or plastering on aerated concrete

Material:

- PVC resistant to alkali and UV
- glass fibre mesh complying with ETAG 004

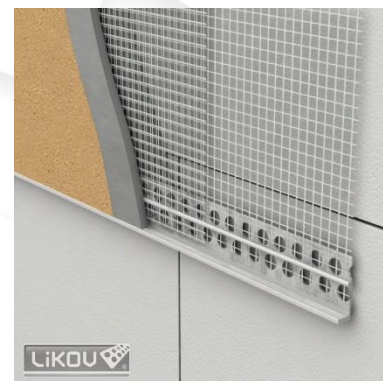
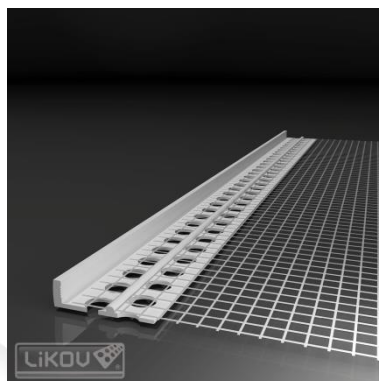

Features:

- Use in the places of plaster transitions to another colour or particle size
- Use in places of transition to another surface finish - cladding strips, concrete etc.
- Individual bead types are adapted to plasters of various grain sizes (3 mm, 6 mm, 10 mm, 15 mm)

Instruction for use:

Place the bead into pre-applied plaster on insulation layer or wall surface. Press it into the plaster and level with spirit level. Then press the bead mesh into the plaster. Remove and level the excess plaster outside the mesh with a trowel. Clean the bead edge when finished the final coat application.

Packaging, storage and transport:

Packed in paper boxes. Store in a dry roofed place at. Transport and store in horizontal position.

Certifications and marks:

The product is not subject to any harmonized standard. The product was voluntarily certified at TZÚS Praha, s.p., The product is certified with certificate number 060-040966.



Technical data:

Bead length [mm]	2000
Mesh width [mm]	100
Edge height [mm]	3, 6, 10, 15
Mesh fixation method	Fixation with plastic rod (absolutely inert in contact with alkali and temperature changes)
Welding rod position (see schemes)	above the plastic profile (6 mm, 10 mm, 15 mm variants) underneath the plastic profile (3 mm variant)

3 mm variant

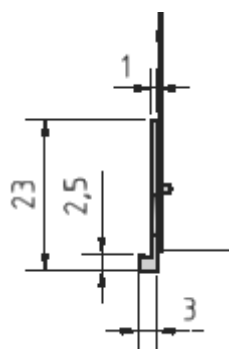

6 mm, 10 mm, 15 mm variants

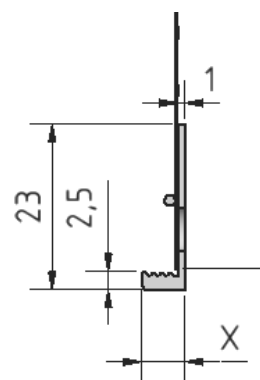

Issued on 18 September 2018.

This update invalidates all previous versions of this technical data sheet. The specified product dimensions are nominal and may range within the permitted manufacturing tolerances.