

LW-L

LW-L set-up bead, in combination with LW-206 bead, forming the set-up kit for thermal insulation boards in thermal insulation system – ETICS/EWI

Material:

- PVC

Features and benefits:

- A part of the set-up kit in combination with LW-206 for ETICS with the thickness of 50-320 mm
- Thermal bridge elimination in comparison with aluminium base profiles
- Quick and easy installation
- Helps make aesthetically perfect and functional detail
- Three product variants according to the different horizontal wing width (50, 100, 160 mm)
- Individual beads can be joined using bundled pegs – versions 050 and 100, dedicated connector profile for version 160

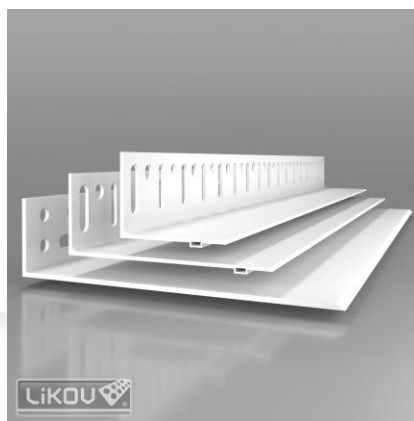

Instruction for use:

Position the LW-L bead to the wall, level with spirit level and mark points for dowel hole drilling. In case of hollow bricks drill without hammering to prevent damage of the inside partitions in the brick. The spacing of the drive-in dowels, ideally ZHH with mushroom-shaped head, should be about 30 to 50 cm. Insert the anchor through the bead hole into the pre-drilled, sufficiently deep and clean hole in the substrate. Anchor the bead by hammering a steel pin into the dowel. A spacer must always be present between the substrate and the bead.

Apply the adhesive on the insulation board and bond it to the substrate by placing over the LW-L bead. Apply at least 15 mm wide strip of base coat mortar on the bottom edge of the front side of the insulation board. Insert the LW-206 bead between the insulation board and LW-L. Use the connecting pegs to connect individual LW-L and LW-206 beads. Remove and level the excess plaster outside the mesh with a trowel.

Conditions of use:

It is forbidden to install the beads at air temperature and surface temperature below + 5 °C and above + 30 °C. It is necessary to protect the bead from direct sunlight and direct weather effects during the whole process until the plasters have dried.

Packaging, storage and transport:

Packed in paper boxes. Store and transport in a dry roofed place, in horizontal position.

Certifications and marks:

The product is not subject to any harmonized standard.

Technical data:

	LW-L	X
Length [mm]	2000	
Width of horizontal arm X [mm]	50; 100; 160	
Thickness of thermal insulation	50-100 (LW-L 50) 100-160 (LW-L 100) 160-320 (LW-L 160)	

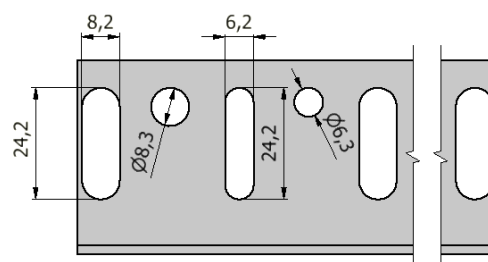
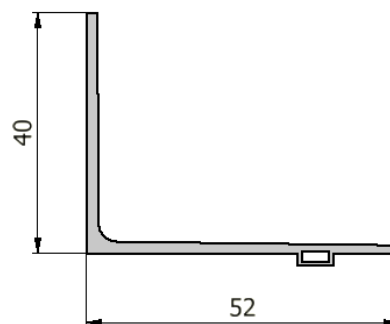

Issued on 19 March 2025.

This update invalidates all previous versions of this technical data sheet. The specified product dimensions are nominal and may range within the permitted manufacturing tolerances.